

Building Sketch

Borrower/Client				
Property Address 160 Stillwater Ln				
City	Roxboro	County	State	Zip Code
Lender				

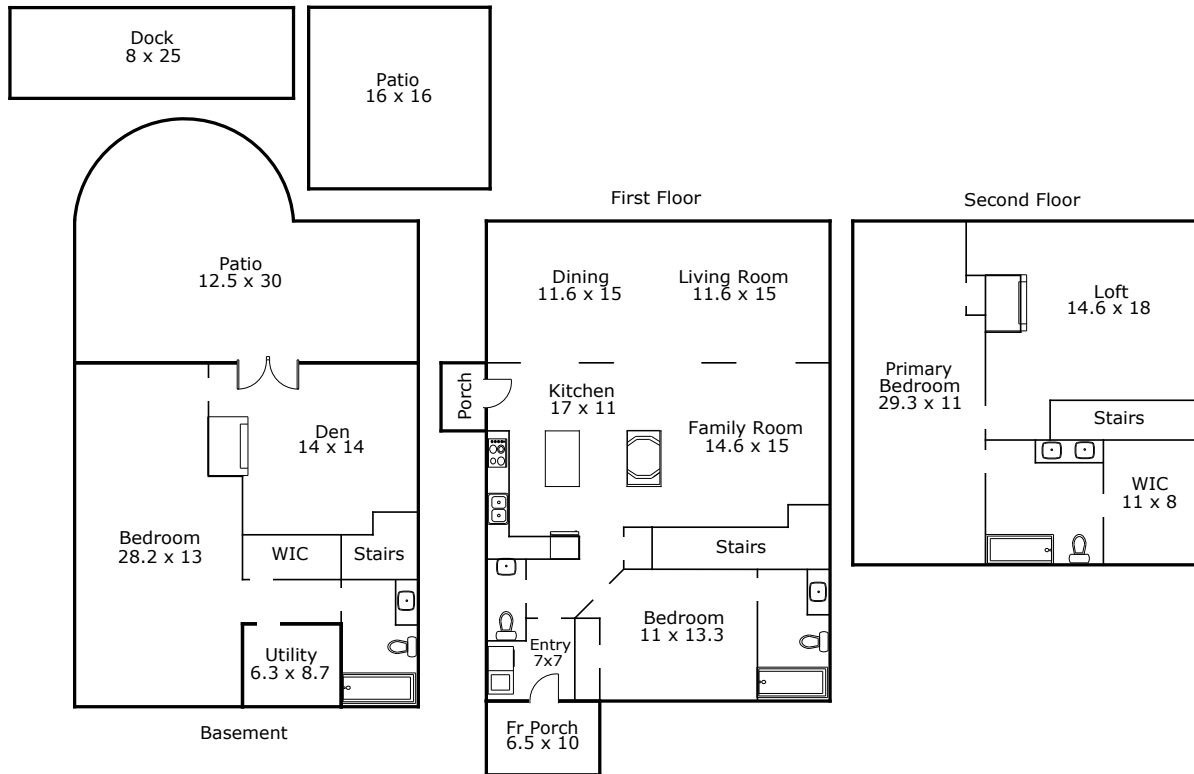

TOTAL Sketch by a la mode

Area Calculations Summary

Living Area	
First Floor	1281.7 Sq ft
Second Floor	918.1 Sq ft
Finished Basement (Below Grade)	854.6 Sq ft
Total Living Area (Rounded):	3054 Sq ft
Non-living Area	
Front Porch	65 Sq ft
Side Porch	24 Sq ft
Patio	512.7 Sq ft
Dock	200 Sq ft
Patio	256 Sq ft
Utility	63.5 Sq ft